

UNIT: mm (毫米)

cdoe

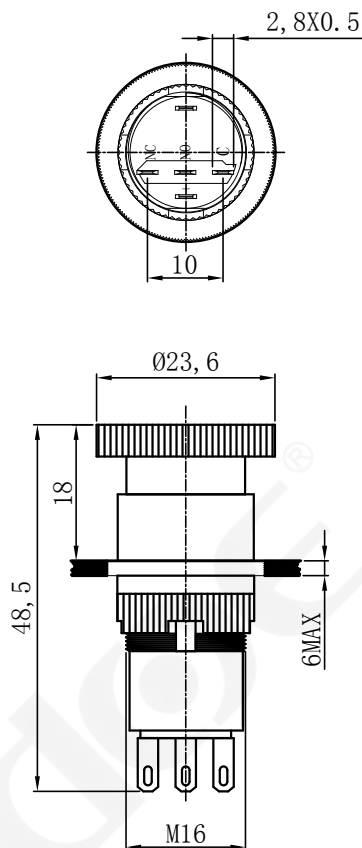

开关结构说明:
Switch structure description:

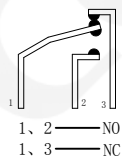

安装孔尺寸:
Mounting hole size:

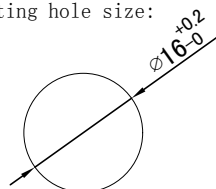

性能要求:

Performance requirements:

1. 防护等级: IP40;
Protection grade: IP40;
2. 接触电阻: $\leq 50\text{m}\Omega$;
Contact resistance: $\leq 50\text{m}\Omega$;
3. 绝缘电阻: $\geq 100\text{M}\Omega$;
The insulation resistance: $\geq 100\text{M}\Omega$;
4. 抗电强度: AC2500V, 1min, 无闪烁、击穿;
Electrical resistance: AC2500V, 1min, no flicker and breakdown;
5. 寿命: 电气部分在额定负载下动作5万次无异常。
Life: Electrical part: operate 50,000 times under rated load without any abnormality.

机械部分: 动作50万次无异常;
Mechanical part: no abnormal movement for 500,000 times

技术要求:

Technical requirements:

1. 表面光洁, 平整无毛刺;
The surface is smooth without burr;
2. 参数/批次字迹清晰, 无错位;
Clear handwriting of parameters/batches without any dislocation;
3. 电气参数: $I_{th}: 5A$ $U_i: 250V$;
Electric parameter: $5A$ $U_i: 250V$;
4. 工作环境温度: $-25^\circ\text{C} \sim +65^\circ\text{C}$;
Working environment temperature: $-25^\circ\text{C} \sim +65^\circ\text{C}$;
5. 动作形式: 自锁式;
Operation type: Latching ;
6. 动作行程: 约3.5mm;
Movement stroke: about 3.5mm
7. 连接形式: 配套接插件/焊接导线;
Connection form: Matching connectors/Welding wire;
8. 拧紧力矩: 约0.4Nm;
Tightening torque: about 0.4Nm;
9. 开关组合: 1NO1NC;
Contact configuration: 1NO1NC;
10. 外观材料: 按键: PC;
外壳: ABS;
螺母: PC
触点: 银合金;
Appearance material: Housing: PC;
Button surface: ABS;
Nut: PC
Contact: silver alloy

11. 未标注公差按照GB/T 1804-m级。

Unmarked tolerance shall be in accordance with GB/T 1804-m class.

描 图

描 校

底 图 号

装 订 号

					YUEQING DAHE ELECTRIC CO., LTD.	
					乐清市大和电气有限公司	
					名称(TITLE):	
					M16 plastic emergency stop switch	
					M16塑料急停开关	
					图号(DWG NO):	
					HBDS1-AY-11TS	
标记	处数	更改文件号	签字	日期		
DR. 制图	APPD. 审核	SCALE. 比例	COUNTERSIGN. 会签	DATE. 日期		
黄	陈秋霞	1:1		2022.3.25		
PW. 单重		P. 页码	第1页 共1页(1/1)			